

USB 2.0 Dual Drives Enclosure

(Card Reader optional)

User's Manual

System Requirements

- ◆ Notebook or Desktop PC with USB2.0 or USB1.1 port
- ◆ Windows 98SE/Me/2000, or Windows XP.
- ◆ Mac OS 9.x or above (Mac OS 10.x is recommended for Card Reader)

NOTE:

- ◆ ***USB2.0 host supports 480Mbps (maximum) data transfer rate, USB1.1 host only supports 12Mbps (maximum) data transfer rate. Check your PC system to make sure you have the right hardware to gain the maximum performance.***
- ◆ ***Mac OS 9.x users can only use Hard Disk Drive without Card Reader feature. Therefore, use Mac OS 10.x or above is recommended.***

Part Names and Functions

1. **3.5" Hard Disk Drive (Top drive or B drive):** Supports 3.5" IDE/ATA hard disk drive.
2. **5.25" Optical Drive or 3.5" Hard Disk Drive (Bottom drive or A drive):** Supports either 5.25" IDE/ATAPI optical drive such as DVD±RW, DVD-ROM, CD-RW, CD-ROM drive or 3.5" Hard Disk Drive.
3. **USB 2.0 Hub:** Your PC can connect to more USB devices through this hub.
4. **Card Reader Switch:** Activates Card Reader.
5. **LED (Green):** Indicates the data-access of memory cards.
6. **5-in-1 Card Slot:** Card slot for SD, MMC, MS, MS Pro and xD-Picture memory cards.
7. **LED (Yellow):** Indicates the power of the bottom drive (A drive) is on and the data-access of the drive.
8. **LED (Green):** Indicates the power of the top drive (B drive) is on and the data-access of the drive.
9. **CF Card Slot:** Card slot for Compact Flash (type I & II) memory card and Micro Drive.
10. **CF Card Ejector:** Push to eject the memory card from CF Card Slot.
11. **Line Out Jack:** Use this jack to output audio signal of optical drive to an audio amplifier.
12. **Power Switch:** Power-on to activate the top and bottom drives, and to provide extra power from AC adapter to USB 2.0 Hub.
13. **External Power Jack:** Connects to the AC adapter.

14. **USB 2.0 uplink port:** Through the attached USB 2.0 cable, this port links this enclosure to PC.

15. **2nd USB 2.0 Hub:** Your PC can connect to other USB devices through this hub.

16. **Kensington Lock Connector.**

1 Front Panel for the Enclosure model with Card Reader

2 Front Panel for the Enclosure model without Card Reader

3 Rear Panel for both Enclosure models

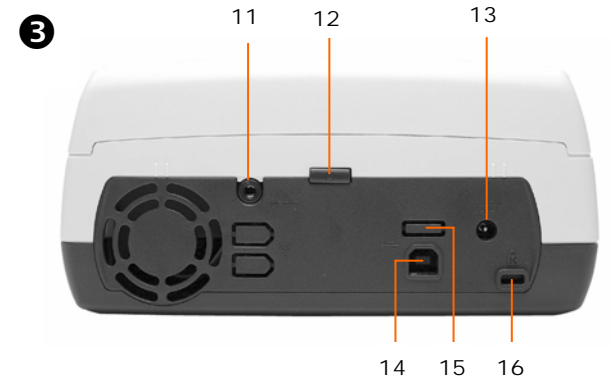
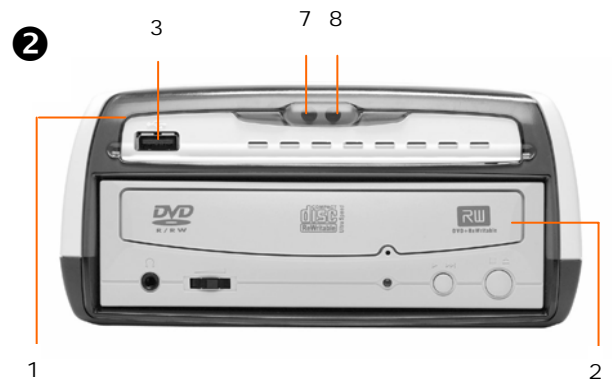
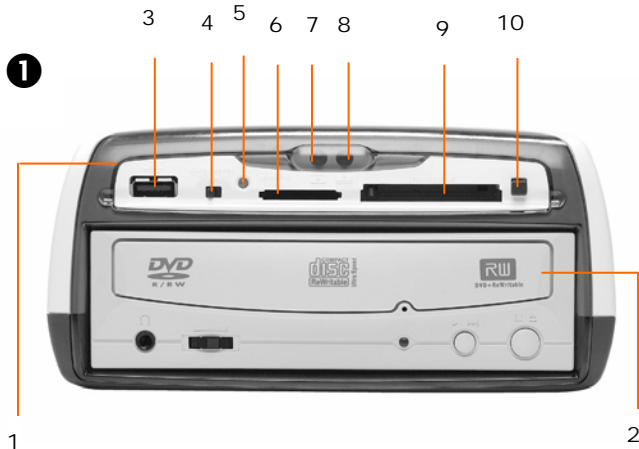

How to Assemble Top Drive (3.5" H.D. Drive)

- 1 Gently pull the top cover backward with both hands, and then lift up the cover to separate it from the enclosure.



- 3 Move the drive backward and forward until it is latched. Fasten the screws on both sides to fix the hard disk drive.

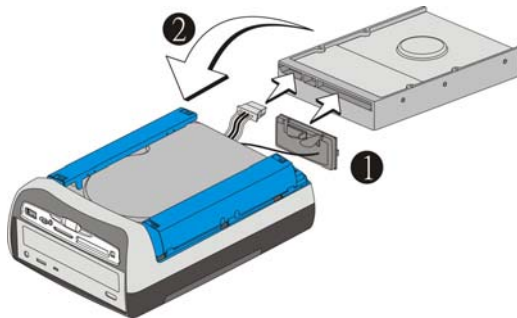

- 2 Attach the IDE and power cables to hard disk drive, and then put it into the enclosure.

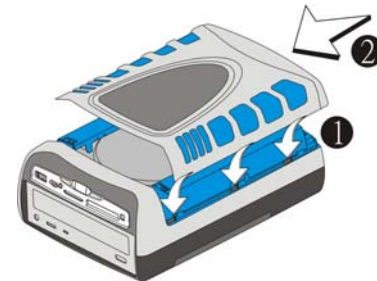

- 4 Align latches of top cover and enclosure; then put the cover onto enclosure. Hold top cover and then push forward to fix it.

How to Disassemble Top Drive (3.5" H.D. Drive)

- 1 Gently pull the top cover backward with both hands, and then lift up the cover to separate it from the enclosure.

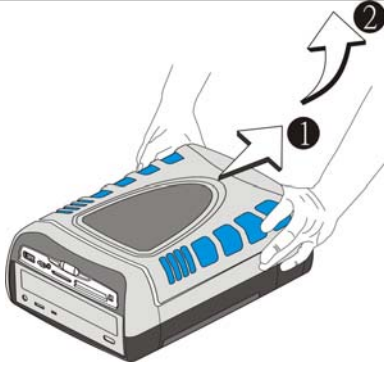

- 3 Take out the drive from the enclosure, and then pull out the IDE and power cables from the drive.

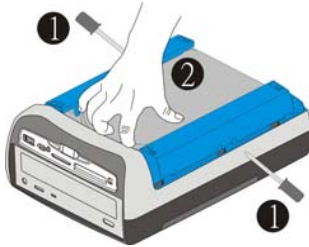
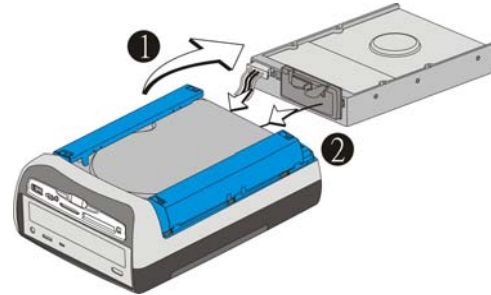

- 2 Loosen the screws on both sides, use fingers to lift up the front side of the hard drive to release the latches.

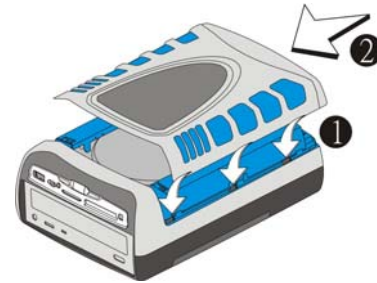

- 4 Align latches of top cover and enclosure; put the cover onto the enclosure. Hold the top cover and then push forward to fix it.

How to Assemble Bottom Drive if it is an Optical Drive

1 Turn over enclosure, use thumbs to push latches of the small cover, and then separate the small cover from the enclosure.



3 Attach the IDE, power and audio cables to the optical drive, and then load the drive into the enclosure completely.

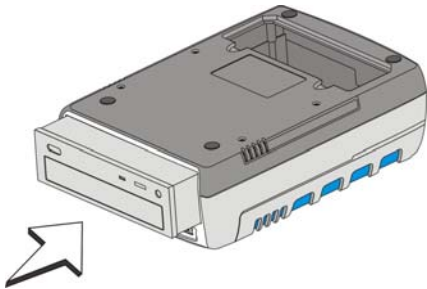

2 Turn over the optical drive, and then load the optical drive into the enclosure.

4 Fix the optical drive with screws. Insert the rear of the small cover into enclosure, and then push cover downward to fix it.

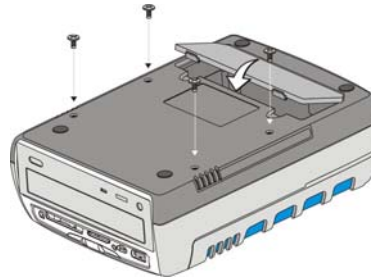

How to Disassemble Bottom Drive if it is an Optical Drive

- 1 Turn over the enclosure; loosen screws. Use thumbs to push latches of small cover; separate small cover from enclosure.

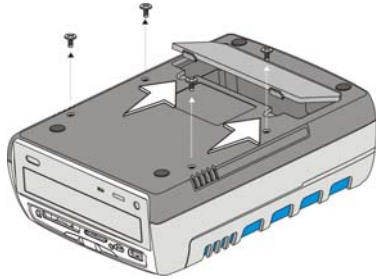

- 3 Push the rear side of the optical drive and then pull from its front side to separate it from the enclosure.

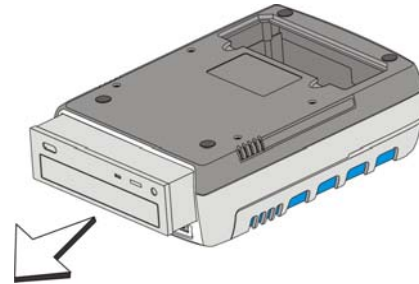

- 2 Pull out the IDE, power and audio cables from the optical drive.



- 4 Insert the rear side of the small cover into the enclosure; push the cover downward to fix it.

Software Installation

Install Device Driver from the Driver CD

1. Boot-up computer into Windows. **Do not connect the enclosure to computer until the Device Driver is successfully installed.**
2. Insert the “Driver CD” into the CD-ROM drive, the welcome screen will pop-up automatically. If the welcome screen does not pop-up, double click “My Computer”, double click the CD-ROM contains the “Driver CD”, and then double click “autorun.exe” to open the welcome screen.
3. Click “Install Device Driver”, follow the instruction on screen to install the following drivers:
 - ◆ If you are using Windows 98SE, please install “Win98SE Driver for Storage Device” first, and then (only for the enclosure model w/card reader) install “Driver for Card Reader”.
 - ◆ If you are using Windows XP/2000/Me, please install only the “Driver for Card Reader”. The driver for hard disk and optical drive is already built-in in the Windows systems.
4. After installing the device driver, now you can connect the enclosure to computer for the system to recognize the device.

Connect the Enclosure to Computer for the very First Time

1. Make sure both the “Power Switch” and “Card Reader Switch” are switched to “OFF”.
2. Plug the AC adapter into the “External Power Jack” at the rear of the enclosure.
3. Attach the AC adapter to the AC power outlet.
4. Plug one end of the USB cable into the “USB 2.0 uplink port” at the rear of the enclosure.
5. Plug the other end of USB cable into computer. (Make sure the AC adapter is properly connected before connecting the enclosure to PC.)
6. The driver for USB 2.0 Hub will be installed immediately and automatically.
7. Shift the “Card Reader Switch” to “ON”, the driver for Card Reader will be installed automatically. Two new drive icons are now present in “My Computer”; they are the Card Readers; you can access data with these two drives (card readers) after inserting the memory card.



CF Card Slot
drive icon



5-in-1 Card Slot
drive icon

8. Push the “Power Switch” to “ON”, and the driver for the drive (hard disk and optical drive) will be installed automatically. The new drive letters are now present in “My Computer” for the connected drives.
9. All drivers are installed successfully, and you can now use the enclosure.

Use the Enclosure

There are several features integrated into the enclosure, please follow the table to activate the features:

Feature	Power Source	Power Switch	Card Reader Switch	AC Adapter
USB 2.0 Hub	Bus-Power ^{*1}	OFF	Can Ignore ^{*3}	Not connected
	Self-Power ^{*2}	ON	Can Ignore ^{*3}	Connected
Card Reader	Any of the above	ON/OFF	ON	Any of the above
Hard Disk Drive and Optical Drive	Self-Power	ON	Can Ignore ^{*3}	Connected

^{*1} Bus-Power: get power from the USB port of computer. (Not recommending using Bus-Power; Self-Power is better.)



^{*2} Self-Power: get the power from the AC adapter. (And the Power Switch must be turned on)

^{*3} Switch on the "Card Reader Switch" will reduce the performance of the external drives and USB 2.0 Hub.

Suggestions:



1. Always use Self-Power, although the Card Reader can almost always and the USB 2.0 Hub can often get enough power using Bus-Power.
2. Turn off the Card Reader Switch when Card Readers are not in use.

Use the USB 2.0 Hub

- ◆ **When using Bus-Power, each port of the USB 2.0 Hub provides 100mA current, please connect with low power consumption devices such as USB mouse or keyboard.**
 - ◆ **When using Self-Power, each port of the USB 2.0 Hub provides 2A current in total.**
1. By attaching the USB cable, you can use the hub with Bus-Power.
 2. If you want to use Self-Power, attach the AC adapter and then push the “Power Switch” to “ON”.
 3. The USB 2.0 Hub is ready to use, you can connect your USB device to the port.
 4. To stop the connection of your USB device, click  or  on system tray to “Safely Remove” the related device, and then un-plug the device from the port.



Use the Card Reader

Activate the Card Reader will reduce the performance of the external hard disk drive; please turn off the Card Readers when they are not in use.

1. Attach the USB cable and then push the “Card Reader Switch” to “ON”.
2. Insert the memory card into the related slot (take notice in the direction of the card), and then access the data from “My Computer”.
3. To take out the memory card, first, ensure the memory card is not accessing data, and then push the ejector (CF memory card), or pull out the card (SD memory card) directly.
4. To stop the Card reader feature, click  or  on system tray (or  under Win98) to “Safely Remove” the related drive letter, and then push the “Card Reader Switch” to “OFF”.

Use the External Hard Disk and Optical Drive

Some hard disk drives may require AC adapter with higher power rating. Please contact your dealer for details.

1. Attach the USB cable and AC adapter, and then push the “Power Switch” to “ON”, the hard disk and optical drive will be recognized immediately for use.
2. To stop using the hard disk or optical drive, click  ,  or  on system tray to “Safely Remove” the related drive letter, and then push the “Power Switch” to “OFF”.

How to Partition the Hard Disk Drive

Note: Please look up the partitioning procedure (especially the cautions) in the attached Driver CD.

